

FORWARD CLUTCH, 3-4 CLUTCH HYDRAULIC CIRCUIT OUTLINE

B3E051701030A26

- By designing exclusive passages for the forward clutch and the 3-4 clutch in the transaxle case, via the oil pump and end cover the hydraulic pressure passages are shortened and control during clutch engagement is improved.

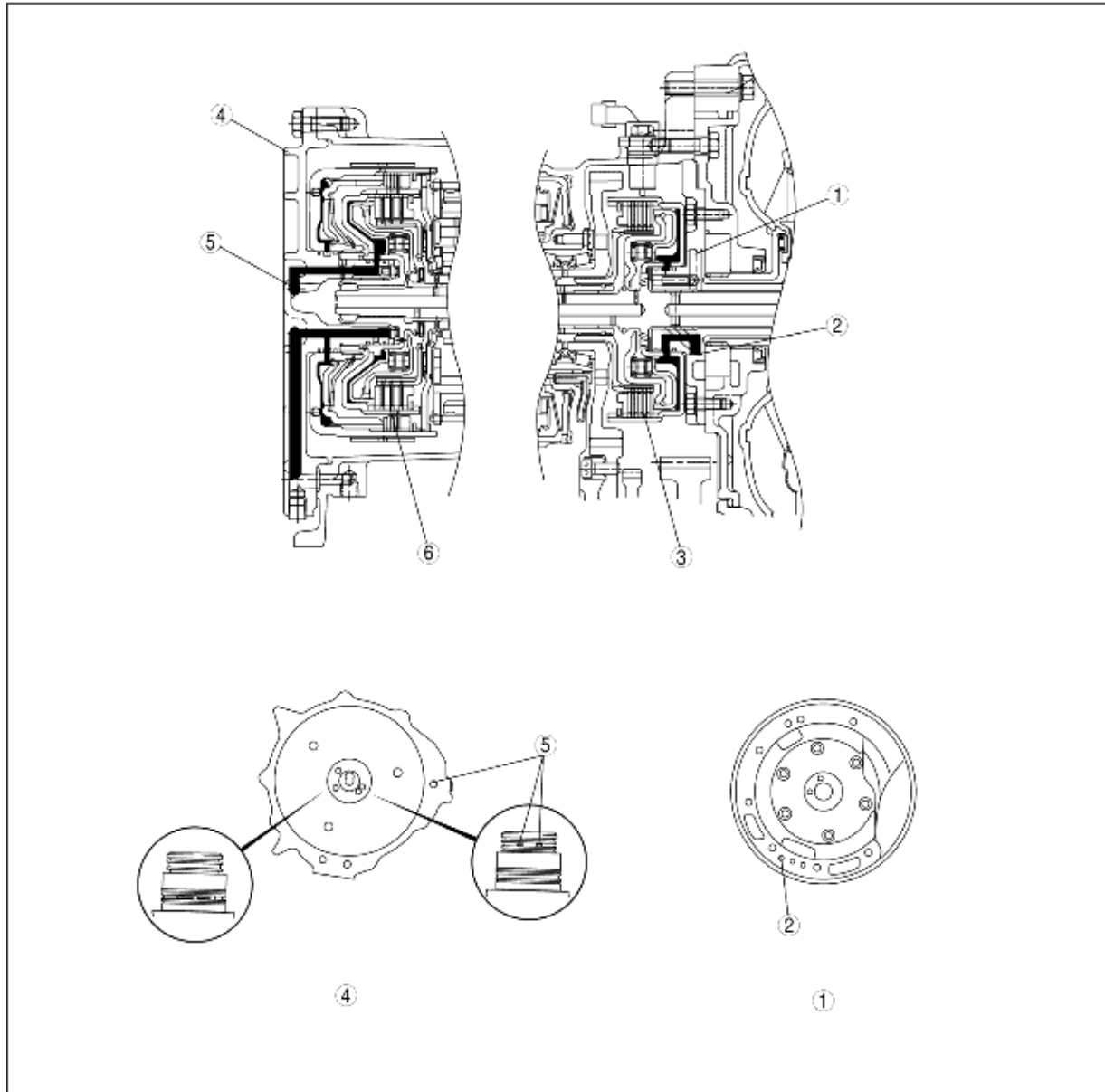

B3E05 17T019

1	Oil pump
2	Forward clutch hydraulic passage
3	Forward clutch
4	End cover
5	3-4 clutch hydraulic passage
6	3-4 clutch